

wall
meow-nted
cat
climbers



pryde™

installation manual for gyprock / drywall

contents

welcome	2
important - please read	3
what's in the box set?	4
planning ahead	5
tools required.....	6
installation steps.....	6
care & maintenance	11
product registration.....	11
customer satisfaction & returns	11

welcome to your pryde

Meowdy Fellow Cat-Lover,

And congratulations on your new Pryde™ Cat Climbers. Our cat-loving team wishes you many happy moments in a home filled with harmony and playful paws.

Our company's mission is to provide our customers with products that are made from high-quality materials and designed with the practical needs of cats and the aesthetic desires of cat owners in mind.

We hope you found exactly what you've been looking for, and you and your cat love it! Thank you from the bottom of our cat crazy hearts for trusting us with this investment.

For questions regarding installation, care, or anything that this manual doesn't answer, please reach out to our Customer Care team who will look after you.

Cat-ch you later!

The Team at Pryde™

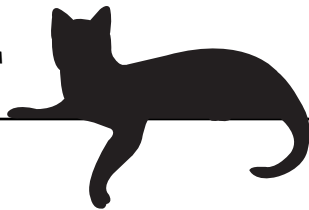

Don't pussyfoot around. Reach out to us anytime!

Our social community details are:



@prydepets



@prydepets

Our contact details are:

Email: hello@prydepets.com.au

Website: www.prydepets.com.au

important - please read

- **Read all instructions and recommendations in this Installation Manual BEFORE commencing installation.**
- Installation hardware such as screws, spring toggle anchors and the appropriate drill bits are NOT included, as different walls and building materials require different solutions.
We recommend you consult a professional and visit a hardware store to ensure proper fixing for your particular wall.
- To ensure your feline friend's safety we recommend planning the placement of the climbers according to the maximum placement measurements (see diagram on page 5).
- Safety testing has been conducted fixing one internal point of each climber into a stud.
Ensure one of the two inner fixing points (on the curved and long brackets) and the centre fixing point (on the short brackets) is being fixed into a stud (see diagram on page 6).
Failure to do so is at your own risk.
- For domestic and indoor use only.
- Please keep these installation instructions for future reference.

what's in the box set?

1 x Curved 'Nest'

Including: Metal Bracket
Felt Slices
Three bolts (inserted)

Size: W:420mm x D:221mm x H:126mm
W:16.5" x D:8.7" x H:4.9"

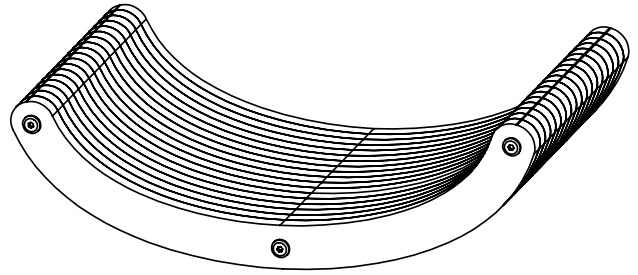

1 x Long 'Lounger'

Including: Metal Bracket
Felt Slices
Three bolts (inserted)

Size: W:420mm x D:221mm x H:35mm
W:16.5" x D:8.7" x H:1.4"

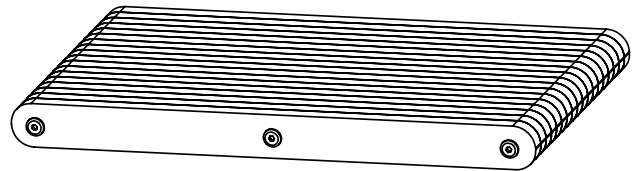

2 x Short 'Steps'

Including: Metal Brackets
Felt Slices
Four bolts (inserted)

Size: W:210mm x D:221mm x H:35mm
W:8.25" x D:8.7" x H:1.4"

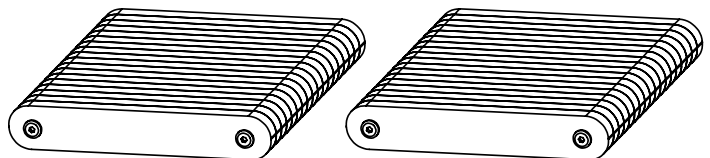

1 x Allen Key/Hex Wrench



If anything is missing, please email us immediately: hello@prydepets.com.au

planning ahead

To ensure your feline friend's safety we recommend the following **maximum placement measurements** - as we're all too familiar with how energetic, powerful and a little bit crazy our cats can get, especially when the zoomies kick in after a long cat nap!

Placement near an item of furniture such as a desk, sofa or armchair allows easy accessibility.

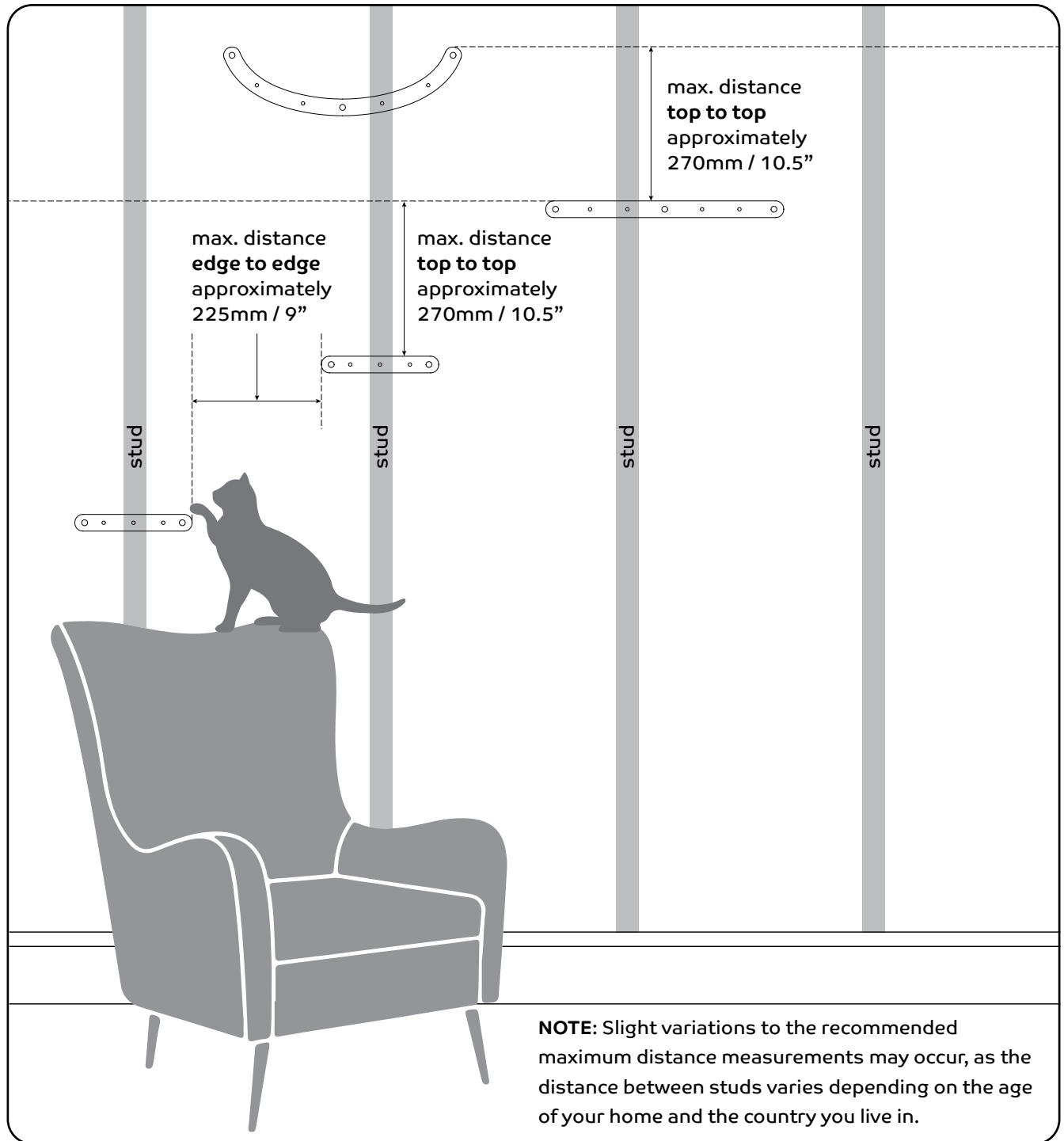

time to get your paws on some tools!

1 x stud finder



1 x spirit level



1 x power drill

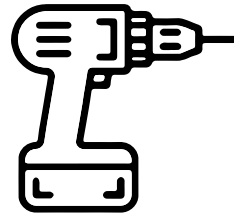

1 x screwdriver

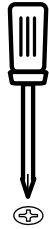

disclaimer

The following hardware and installation instructions (pages 6 - 10) were used successfully during safety testing at Pryde™ headquarters. However, as different walls and building materials require different solutions, we recommend you consult a professional and visit a hardware store to ensure proper fixing for your particular wall.

Ensure one of the two inner fixing points (on the curved and long brackets) and the centre fixing point (on the short brackets) is being fixed into a stud (see diagram below). Failure to do so is at your own risk.

4 x flat top head screws
one fixing hole per climber
to be screwed into a stud



10 x spring toggle anchors
minimum load per anchor 10kg / 22lbs

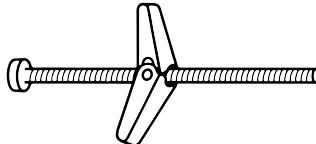

2 x drill bits
1 for stud fixing
1 for toggle anchor fixing

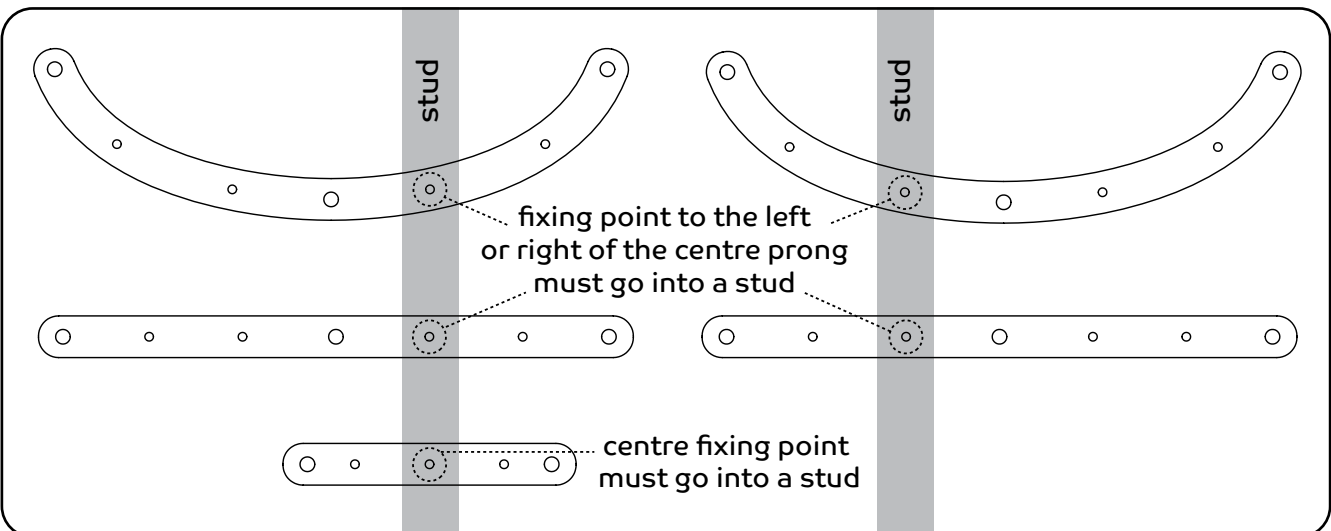

step 1

Using the included Allen Key/Hex Wrench, remove the bolts on each Climber and gently slide all the felt slices off the bracket (only remove a few slices at a time).

Using a stud finder, locate and mark the stud with a pencil at your desired location.

Hold the metal bracket straight at your desired location, checking it with a spirit level.

Mark the centre of each fixing hole with a pencil.

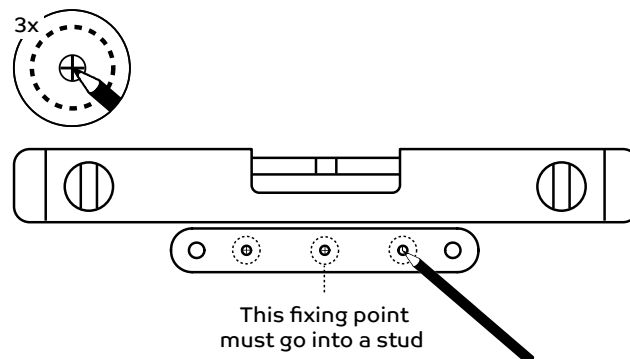
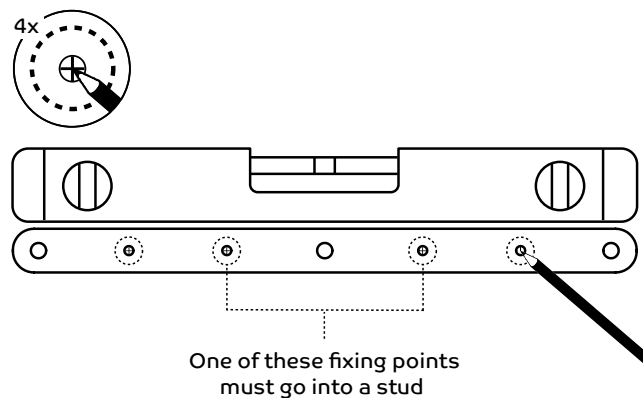
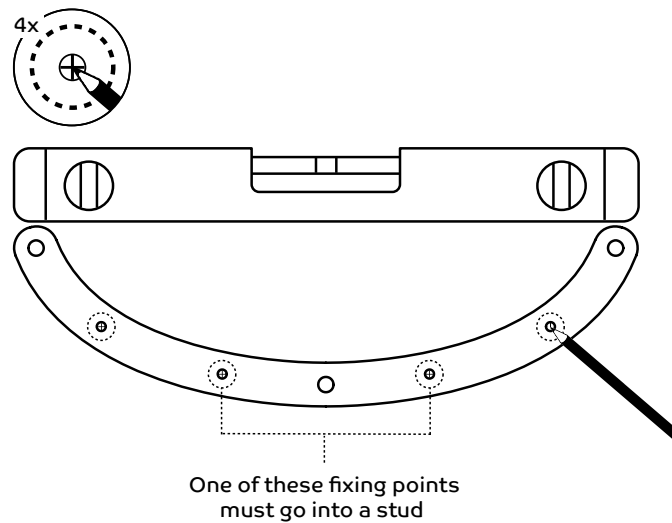

step 2

Drill holes for the spring toggle anchors using an appropriate sized drill bit for the anchors purchased.

Drill a pilot hole for the stud fixing screw using an appropriate sized drill bit for the screws purchased.

For Curved and Long Climbers:

drill toggle anchor holes here if you chose the stud fixing point to the **right** of the centre prong

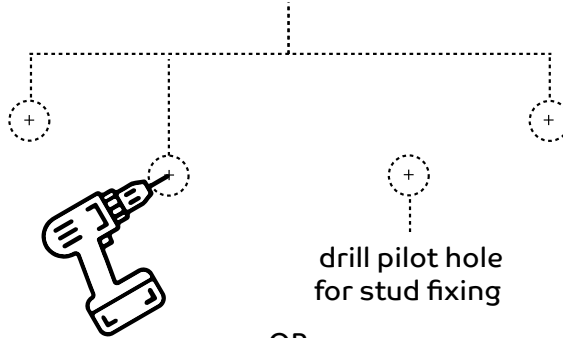

OR

drill toggle anchor holes here if you chose the stud fixing point to the **left** of the centre prong

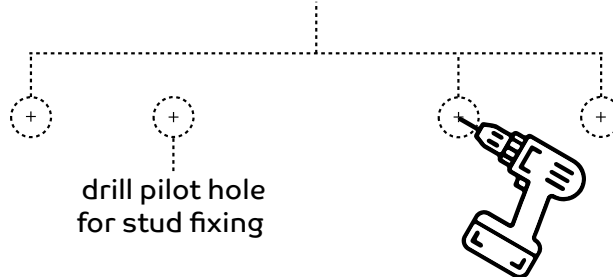

For Short Climbers:

drill toggle anchor holes here

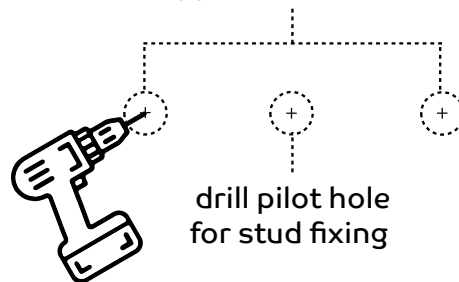

step 2 continued

Unscrew the toggle part of the anchor.

Insert bolt through one of the holes in the metal bracket (not the hole that is reserved for the stud) then screw the toggle back onto the bolt (no more than 1 cm / half an inch).

Repeat for the remaining toggle holes.

Squeeze the toggle together and insert all spring toggle anchors into the appropriate drill holes.

NOTE: Insert all toggle anchors before screwing the stud fixing point.

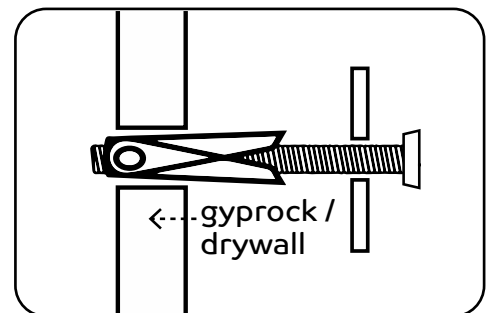
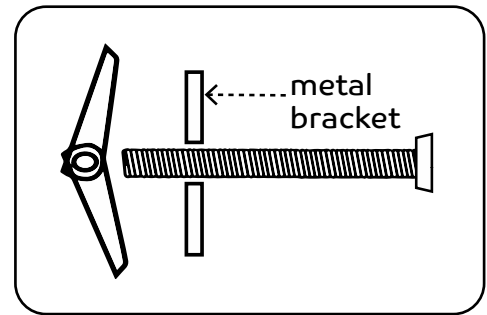

step 3

Toggle Anchor Fixing Points:

Ensure the toggles have splayed open behind the gyprock / drywall - test this by pulling the bracket gently towards you.

Constantly pull the bolt towards you while you screw it in to ensure the splayed toggles remain hard up against the gyprock / drywall surface. Do not tighten the bolts completely at this point.

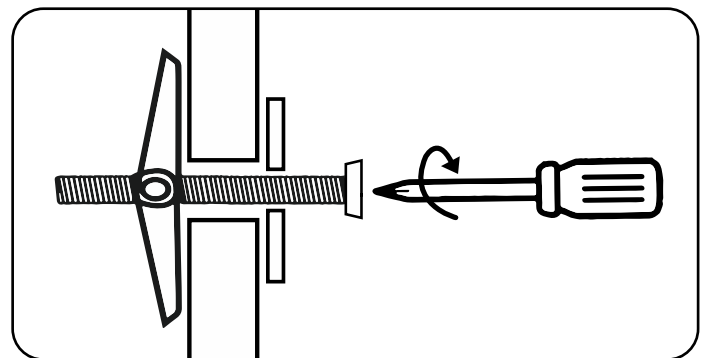

Stud Screw Fixing Point:

Next, using a screwdriver, insert the screw into the hole in the stud and tighten completely.

Now completely tighten the toggle bolts using a screwdriver.

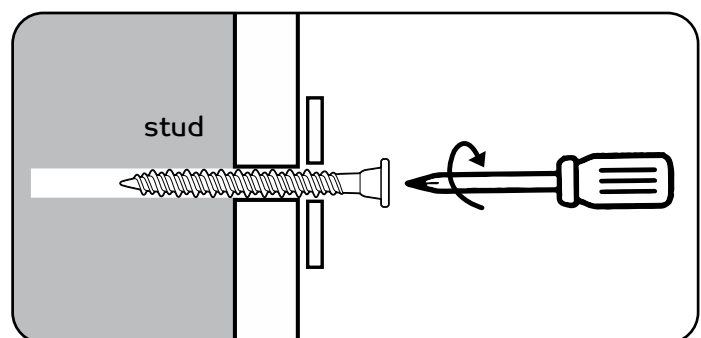

step 4

Once the metal bracket is fixed to the wall, slide the felt back onto the bracket prongs.

Insert the hex bolts into the ends of the prongs and use the supplied allen key / hex wrench to tighten and keep the felt in place.

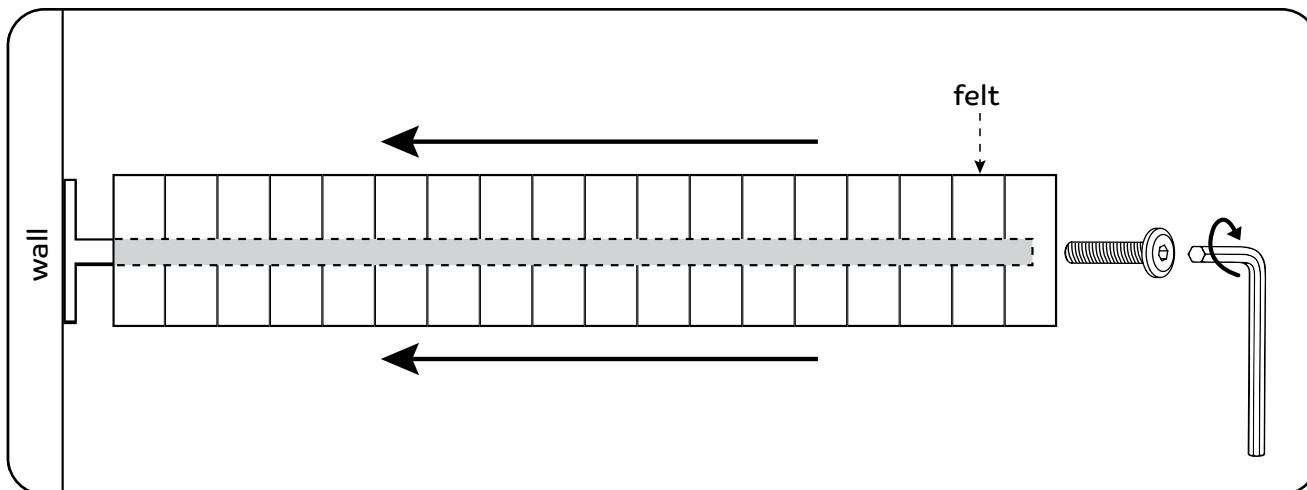

step 5

Kick back and watch your feline friend enjoy their new favorite hangout!



care and maintenance

Made from PET felt. This soft, but firm material is made of 100% recycled plastic bottles, making it a highly sustainable option.

It has other big advantages, such as easy maintenance and being long-lasting.

The PET felt fabric can also be recycled and reused again.

- Spot clean with a damp cloth or soft brush.
- A mild detergent may also be used if required.
- We do not recommend submerging felt in water.

register meow!

As a valued customer, we invite you to register your product to unlock a range of benefits.

By registering, you'll be eligible for discounts on additional sets, be the first to find out about our VIP deals and extended warranty coverage.

We take your privacy seriously, and promise to keep your personal details confidential and not share them with any third parties. Simply visit our website and follow the instructions to complete your registration.

www.prydepets.com.au/register

customer satisfaction & returns

If for any reason you're not completely satisfied with your purchase, please contact us.

If returning the item, please ensure that you safely pack the item into the original packaging with all included accessories e.g. bolts. Please then seal inside a secondary box for shipping. Items that arrived damaged or missing accessories may be subject to a restocking fee.

We thank you in advance for providing us the opportunity to resolve the issue for you.

Email us at: hello@prydepets.com.au

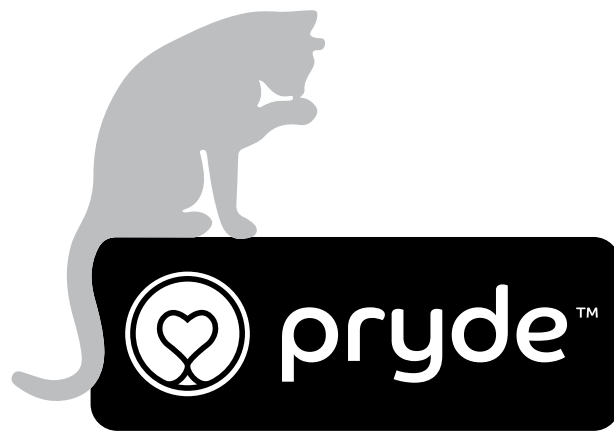

www.prydepets.com.au

WARNING: Manufacturer and seller expressly disclaim any and all liability for personal injury, property damage, or loss, whether direct, indirect or incidental, resulting from the incorrect attachment, improper use, inadequate maintenance or neglect of this product.